



# CABLE REEL 560

## CAMERA CABLE REEL WITH SLIP RINGS

Cable reel 560 is a cable reel with slip rings used for camera cables. It is designed for fixed installation with placement for example on a refueling machine or fuel bridge.

### APPLICATIONS

- For fixed installation on refueling machines and fuel bridges

### BENEFITS

- Automatic tension control during winding and unwinding.
- Equipped with ratchet.
- Integrated camera cable connectors.
- Specially designed for prolonging the camera cable lifetime through eliminating cable twisting in more than one direction.
- Motorized cable reel, option.

### SPECIFICATIONS

Slip rings	Yes
Maximum cable length	40 m (1576")
Drum diameter	300 mm (11,82")
Outer diameter	550 mm (21,67")
Width	324 mm
Weight without cable	35 kg (77 lbs)
Motorized cable reel	Speed and torque depends on payload and cable length, 30kg payload = 0,2 m/s Powered by 2A@24VDC Position feedback and memorized positioning possible

*We reserve the right to alter specifications without prior notice*

### CABLE REEL 560 IMAGES

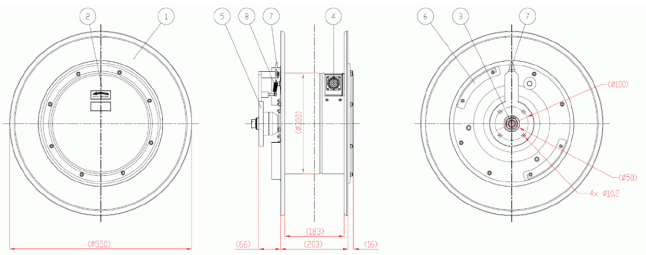

*We reserve the right to alter specifications without prior notice*

## LINKS

 English

[ahlbergcameras.staging.westart.se/products/cables/cable-reel-560](https://ahlbergcameras.staging.westart.se/products/cables/cable-reel-560)

*We reserve the right to alter specifications without prior notice*

---