



CCTV90

HIGH TEMPERATURE AND NEUTRON TOLERANT CCTV CAMERA

CCTV90 is designed for areas with high levels of gamma and neutron radiation. A typical surveillance area is the containment in a PWR/BWR reactor. The camera features an internal cooling system in order to handle high temperatures and humidity in the containment during a possible LOCA.

APPLICATIONS

- CCTV camera for nuclear plant areas with high levels of gamma and neutron radiation.
- Surveillance of containment or drywell where possible high temperature is handled by the camera's internal cooling system

BENEFITS

- Auto-focus and auto-iris
- Neutron radiation tolerant color camera
- High temperature tolerant
- Available in SD/HD video version

SPECIFICATIONS

Dimensions	364 x 217 x 272 mm (14.33" x 8.54" x 10.71")
Weight	33.2 Kg (73.2 lbs)
Housing material	Stainless steel EN 1.4301
Radiation tolerance (dose rate)	1 000 Gy/h (100 000 rad/h)
Radiation tolerance (total dose)	10 000 Gy (1 000 000 rad)
Radiation tolerance neutrons	High
Maximum temperature	80°C (176°F), 90°C (194°F) for 5 hours
Cooling	Peltier elements
Protection class	IP65 (70°C)
Zoom	x10 optical x10 digital giving x100
SD horizontal angle of view	approx. 37.5° (wide end), approx. 4° (tele end)
HD horizontal angle of view	Approx. 50° (wide end), approx. 5° (tele end)
Resolution SD version	720 TV-lines
Resolution HD version	720p

We reserve the right to alter specifications without prior notice

CCTV90 IMAGES

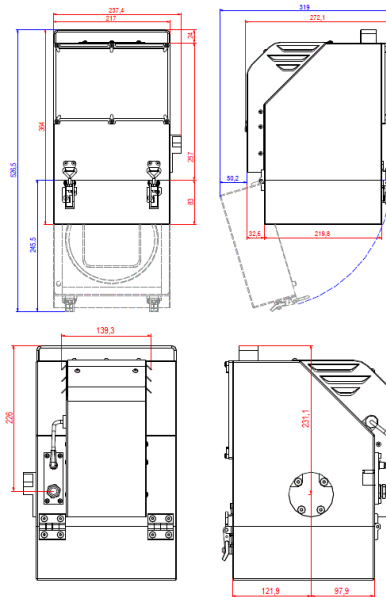

LINKS

 English

ahlbergcameras.staging.westart.se/products/cctv-cameras/cctv90

We reserve the right to alter specifications without prior notice